

INCOMING RAW MATERIAL

MATERIAL STORAGE PILE

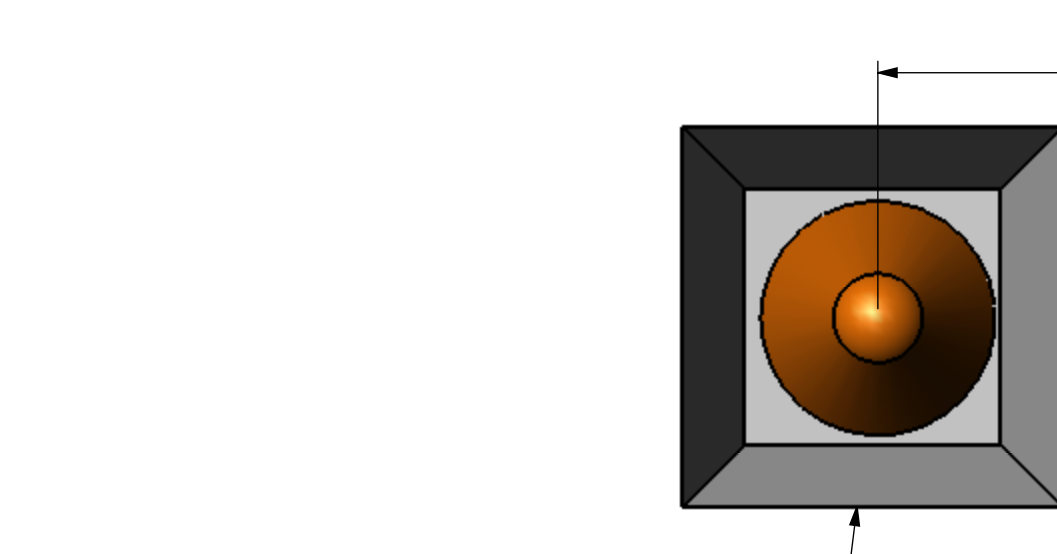

INITIAL FEED HOPPER

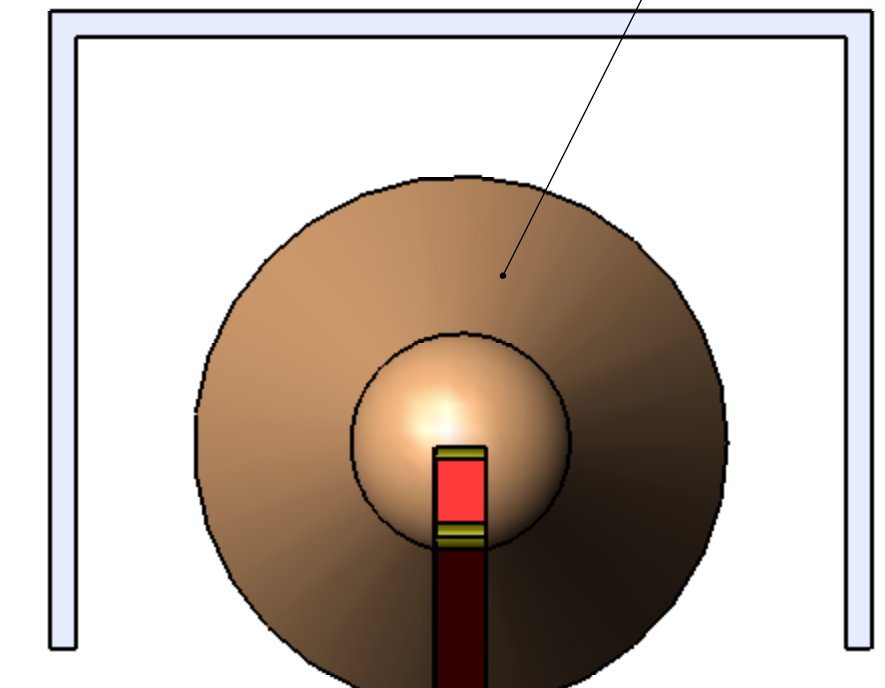
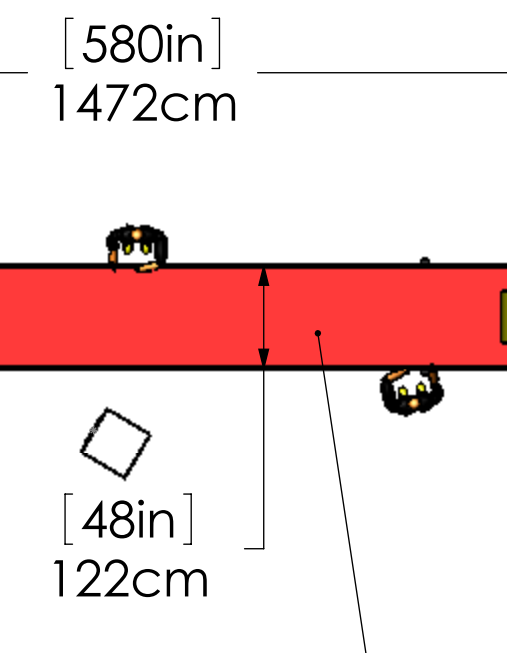

PRE-SHREDED SORTING CONVEYOR
PART# WESTERIA Infeed Conveyor
WEIGHT: 3400Kg/7480#
122cm x 580cm x 210cm

PRIMARY SHREDDING
PART# Weima Powerline 2500/800
WEIGHT: 33,000Kg/ 72,600#
208cm X 309cm X 241cm high

POSITION DISCHARGE CONVEYOR
PART# WESTERIA BELT TYPE BFK
WEIGHT: 2,500Kg/ 55,000#
100cm x 1800cm x 645cm

EXHAUST HEATED MATERIAL DRYER, CONVEYOR
PART# D4-FLCY-3459
WEIGHT: 400Kg/875#
91cm x 249cm x 243cm High

SECOND HOPPER
PART# D4-07-001-HOPPER
WEIGHT: 450Kg/ 1000# (Empty)
453cm x 332cm x 244cm High

GAS STORAGE BLADDER
PART# GBD-00050 BLADDER STORAGE
PART# CTF-MAN-001
PART# GBD-MAN-002
WEIGHT: 300Kg/ 625#
342cm x 384cm x 195cm High

CARBON CAPTURE AUGER & DRIVE
PART# D4-6X12jHO-AUGER ASSEMBLY
PART# B05120.WANT1-DRIVE
WEIGHT: 585Kg/1288#
80cm x 310cm x 247cm High

D4 UNIT
PART# D4-1.25MW-NODE
WEIGHT: 2240Kg/ 4930#
291cm x 565cm x 321cm High

CYCLONE & FRAME
PART# D4-445-8765
WEIGHT: 477Kg/1050
152cm x 152cm x 763cm High

PRIMARY FEED HOPPER
PART# D4-435-1845
WEIGHT: 1636Kg/ 3600#
122cm x 122cm x 660cm High

PRODUCT GASCOOLER/ FILTER
PART# CTF-00120-COOLER
WEIGHT: 394Kg/ 867#
172cm x 180cm x 602cm High

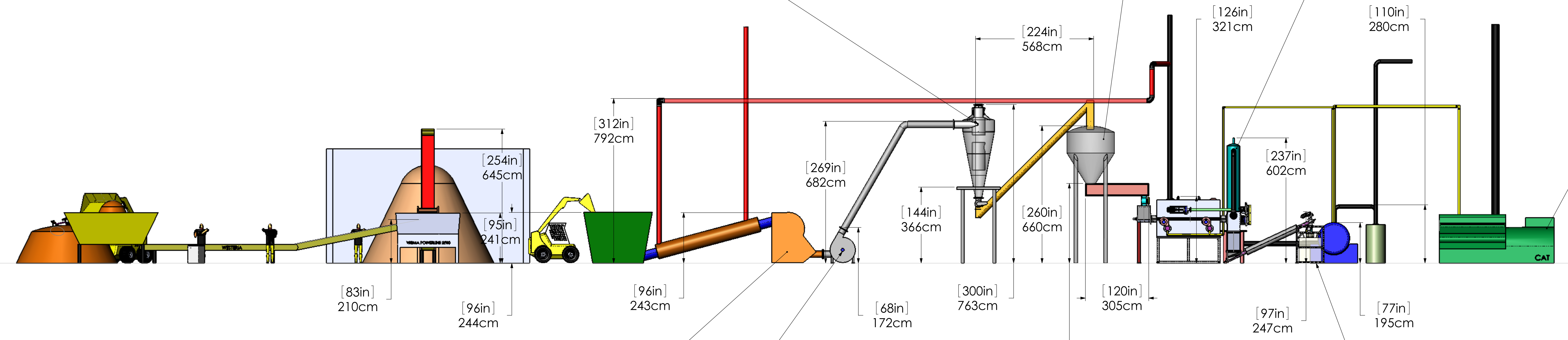

HAMMMER MILL
PART # 35D-5551-08-SEPFAN
WEIGHT: 204Kg/ 450#
90cm x 247cm x 243cm High

BLOWER & TUBE
PART # D4-3EC-2444-08
WEIGHT: 150Kg/ 325#
54cm x 157cm x 682cm High

CAT 1600ekW 2000 kVA GENSET
PART/MODEL # G3516-CAT
WEIGHT: 15,640Kg/34,480#
182.7cm X 234cm X 552cm

SUPER SACK & FRAME
PART# G2531-BB074X BAFTEL SACK
PART# D4-424246- FRAME
WEIGHT: 354Kg/780# (Empty)
142cm x 142cm x 195cm High



UNLESS OTHERWISE SPECIFIED: DIMENSIONS ARE METRIC TOLERANCES: ANGULAR ± 0.5° LINEAR ± 0.5 XXX ± 0.013 DO NOT SCALE DRAWING		UNLESS OTHERWISE SPECIFIED: ALL CORNER/EDGE RADI TO BE .3		PROJECTION		Geometric Symbols ○ CONCENTRICITY ⊙ CYLINDRICITY ∥ PARALLELISM ⊥ PERPENDICULARITY ⊥ SYMMETRY ⊥ PERPENDICULARITY ⊥ TRUE POSITION — STRAIGHTNESS ○ ROUNDNESS		DRAWN: AW DATE: 2-7-11 DESIGNED: N/A CHECKED: 3/9/2011		TOOL NAME: MACHINER DATE: N/A CUSTOMER TOOL #		RDF PLANT POLAND D4 ENERGY GROUP		SHEET 1 OF 1	
---	--	--	--	------------	--	---	--	---	--	---	--	-------------------------------------	--	--------------	--